

11 Rowan Street Bendigo VIC

4 🛏 2 🚿 2 🚗

Large, luxurious, and brimming with period elegance, 'Mandalay' (circa 1890) stands proudly just steps from the iconic Bendigo Arts Precinct, Queen Elizabeth Oval, and Rosalind Park. This freestanding, double-storey beauty, nestled among Bendigo's earliest homes, has had its "wet areas" tastefully restored by the current owners, seamlessly blending old-world charm with modern conveniences.

Type : House
Price : COMING SOON
Land Size : 436 sqm
View : <https://www.dck.com.au/sale/vic/greater-bendigo-region/bendigo/residential/house/8129470>

Beyond the striking red-brick facade, you'll find a formal lounge with a gas heater installed in the fireplace and a separate cosy living room/study, both featuring exquisite open fireplaces, soaring ceilings, ornate cornices, and gleaming timber floors.

[For full version visit the website](#)



Yvette Homewood
(03) 5440 5000



Kaye Lazenby
(03) 5440 5000

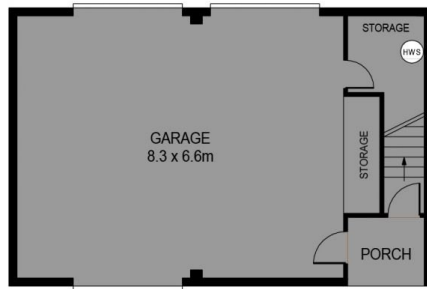

GROUND FLOOR

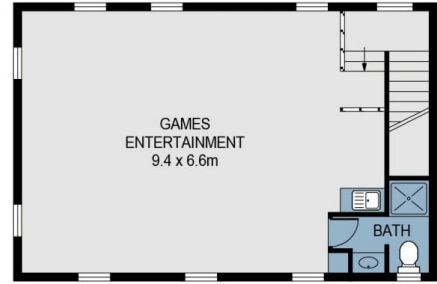

FIRST FLOOR

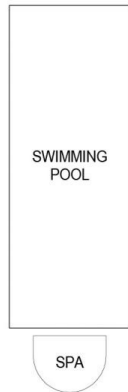

BASEMENT

GROUND FLOOR

FIRST FLOOR



SCALE (METRES)

SCALE IN METRES. INDICATIVE ONLY. DIMENSIONS ARE APPROXIMATE. ALL INFORMATION CONTAINED HEREIN IS GATHERED FROM SOURCES WE BELIEVE TO BE RELIABLE. HOWEVER WE CANNOT GUARANTEE ITS ACCURACY AND INTERESTED PARTIES SHOULD RELY ON THEIR OWN ENQUIRIES.
Ref. No: 240909

INT	:	280m ²
DECK	:	7m ²
GARAGE	:	55m ²
BALCONY	:	17m ²
ALFRESCO	:	14m ²
VERANDAH	:	9m ²
GAMES ENTERTAINMENT	:	60m ²

11 ROWAN STREET

